

# Type 51/0/1

## Connection Head ATEX Exia / ATEX Exd / IECEx Exd

Connection Heads

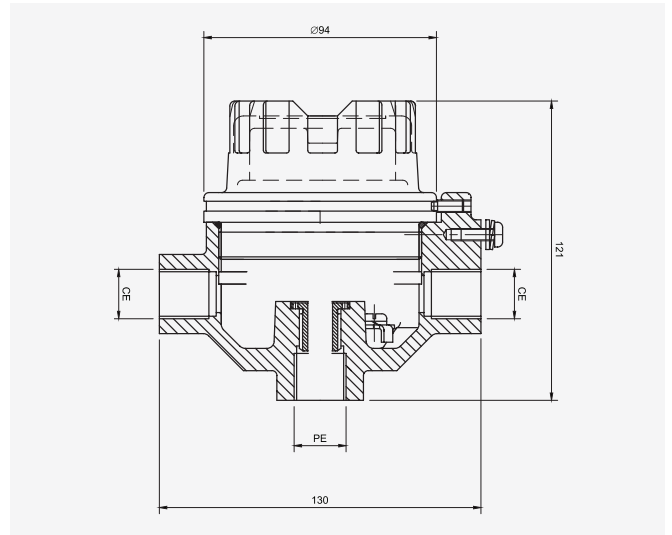

The Type 51/0/1 dual entry connection head is manufactured from high quality aluminium with a tough epoxy painted finish. This aluminium housing can be fitted with most types of ceramic terminal block or DIN standard transmitter and is weatherproof to IP68. If required this connection head can be supplied with ATEX Exia approval for use within intrinsically safe environments or ATEX Exd or IECEx Exd for use within explosive atmospheres when manufactured as part of an assembly by H&B Sensors. Additional options include either a M20 x 1.5 or 1/2" NPT cable entries and either a 1/2" BSPP or 1/2" NPT probe entry.

|                    |                                |
|--------------------|--------------------------------|
| <b>Material</b>    | Aluminium                      |
| <b>Cable Entry</b> | M20 x 1.5 or 1/2" NPT          |
| <b>Probe Entry</b> | 1/2" BSPP or 1/2" NPT          |
| <b>IP Rating</b>   | IP68                           |
| <b>Approvals</b>   | ATEX Exia, ATEX Exd, IECEx Exd |
| <b>Termination</b> | Terminal Block / Transmitter   |
| <b>Weight (Kg)</b> | 0.85                           |

| Approval  | Classification   | Certificate #     |
|-----------|--|-------------------|
| ATEX Exia | ⚠ II 1 GD  | Sira 11ATEX2153X  |
| ATEX Exd  | ⚠ II 2 GD<br>Tamb +55°C to +170°C                                | Sira 00ATEX1029   |
| IECEx Exd | Ex d IIC T6 Gb<br>Ex t IIC T85°C Db IP68<br>Tamb +55°C to +170°C | IECEx SIR 09.0104 |