

Bimetallic Thermometers

Model E

Bimetallic Thermometers



Model E	ASME B40.200
Case Material	316 Stainless Steel (304 stainless Steel on Vertical Model)
Window	Standard Instrument Glass
IP Rating	IP66
Sheath Material	316 Stainless Steel
Stem Ø	6mm, 6.4mm, 8mm, 9.6mm
Maximum Stem Length	1000mm
External Zero Adjustment	Yes
Accuracy	1%
Compression Fitting	1/2" BSPP / BSPT / NPT

The H&B Model E bimetallic thermometers offer high accuracy, grade A (1%) temperature measurement. They feature a 125mm diameter dial with a 316 stainless steel case and stem (304 Stainless steel on the vertical model) and have an IP66 rating. Standard temperature ranges and stem lengths are detailed in the specifications below.

Features

- Optional ATEX approved **CE** & II 2 DG c Tx°C IP66
- Maxivision® dial allows readability from any angle without parallax error
- External adjustment permits zero reset from outside the case
- Dry or liquid filled
- Silicone coil dampening provides vibration dampening and improves response time

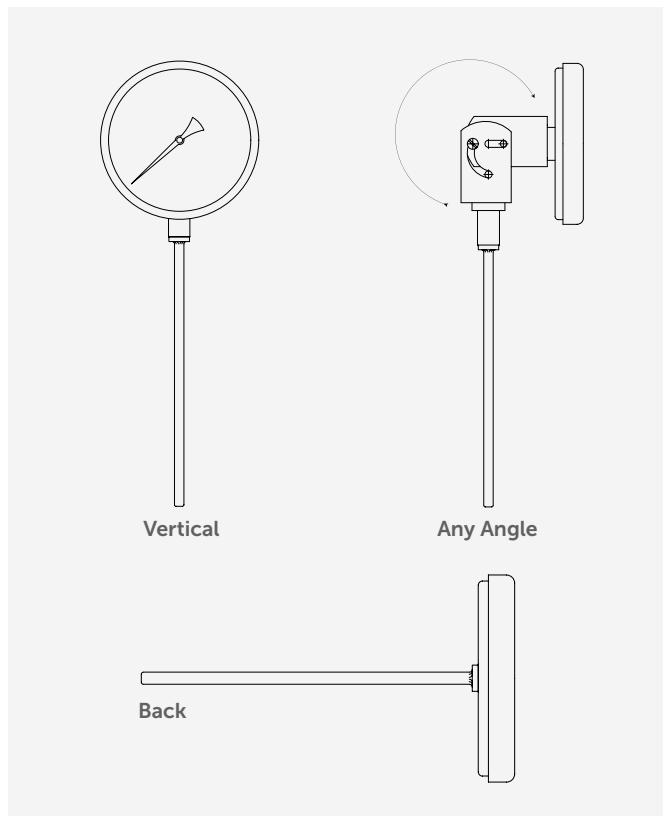

Bimetallic Thermometers

Model E

Options

8mm Ø Stem

9.6mm Ø Stem

Shatterproof Glass Window

Acrylic Window

Silicone Filled (Max+300°C, inc. Acrylic Glass, not available on Vertical Model)

Dual Scale

Stainless Steel Tag

ATEX (Shatterproof Glass Required)

Calibration Certificate

Temperature Ranges °C

0°C / +50°C	0°C / +60°C	0°C / +80°C	0°C / +100°C	0°C / +120°C
0°C / +150°C	0°C / +160°C	0°C / +200°C	0°C / +250°C	0°C / +300°C
0°C / +400°C	0°C / +500°C	+10°C / +150°C	+50°C / +300°C	+50°C / +45-°C
+100°C / +500°C	-10°C / +50°C	-10°C / +110°C	-20°C / +40°C	-20°C / +60°C
-20°C / +120°C	-20°C / +180°C	-25°C / +25°C	-30°C / +50°C	-30°C / +70°C
-40°C / +40°C	-40°C / +60°C	-40°C / +160°C	-50°C / +50°C	

Temperature Ranges °F

0°F / +100°F	0°F / +150°F	0°F / +200°F	0°F / +250°F	0°F / +300°F
0°F / +350°F	0°F / +500°F	+20°F / +120°F	+30°F / +130°F	+30°F / +240°F
+50°F / +300°F	+50°F / +400°F	+50°F / +550°F	+80°F / +180°F	+100°F / +800°F
+160°F / +360°F	+170°F / +270°F	+200°F / +400°F	+200°F / +700°F	+200°F / +1000°F
-40°F / +120°F	-40°F / +160°F	-20°F / +120°F	-80°F / +120°F	-10°F / +100°F